



EFD1-1 Push buttons series

Protection mode:

Type of protection: EX II 2GD EEX d IIB+H²
 Class of temperature: T6
 Protection degree: IP65
 Ambient Temp : -50/+60°C*
 Zones : 1-21-2-22



Description:

Series EFD pushbuttons, made of aluminium light alloy, with external bolts in stainless steel and RAL 7000 epoxy vinyl coating, are available in accord to all different requirements because of their big choice of control and signalling units; it is also available a special model of EFD1 with an emergency button and break glass, complete of external accessories (chain, hammer, glass stop ring, etc) in stainless steel and RAL 3000 external epoxy vinyl coating.

Technicals data:

Materials	Body and cover aluminium alloy Screws in stainless steel
Inhibiting treatment	Standard epoxy painting Grey RAL7000
Electrical elements	
Rated Insulation voltage	Ui 660V (CEI 60947-5-1) 300V (CSA C22-2 n,14) lith 10A
Dielectric strenght	3KV (1s)
Insulation resistance	2 Mohm min (500VCC)
Initial contact resistance	<=25m. Ohm
Short circuits protection	Fuses gl 10A 500V 10.3 x 38 II 100KA
Terminals marking	EN 60079-0(2006), EN 60079-1(2007), EN 61241-0(2006), EN 61241-1(2004)
Connections	Self cleaning type EN01 (NC) EN10 (NO)
Operation frequency	1800 operations/hours maxi
Utilization categories	AC15 Voltage(V)-24-130-230-400 Current(A) 10-6.5-4-2.5 DC13 Voltage (V) -24-110 Current (I) -1.5-0.5

Technical drawing:

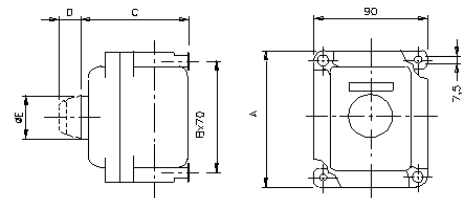

Type	Elément s	Cable entries		Dimensions			Weight Gr
		Ø	Nbrs	A	B	C	
EFD1	1	3/4"	2	106	86	87	480

Elements	Symbole	D	E	Contacts	Weight(g)
Button On	1	20	38	1NO	180
Button Off	0	20	38	1NC	180
Interr. key 2p	7/2	46	38	2NO	400
Interr. key 2p+	7/2D	46	38	2NO+2Nc	400
Switch key 3p	7/2C	46	38	2NO+2Nc	400
Potentiometer*	10	22	45	10Kohms	-

Electrical specification	
Voltage / Current	380 VAC / 10 A

*With incandescent lamps		
Gas	Dust	Tamb
T6	T85°C	-50/ +40°C
T5	T100°C	-50/ +50°C
T4	T135°C	-50/ +60°C

*Commands units only		
Gas	Dust	Tamb
T6	T85°C	-50/ +60°C

EFD1 - 1
 Enclosure 1 element