



EFD1 I2 Push buttons series

Protection mode:

Type of protection: EX II 2GD EEX d IIB + H2
 Class of temperature: T6
 Protection degree: IP65
 Ambient Temp : -50 / +60°C*
 Zones : 1-21-2-22

Description:

Series EFD pushbuttons, made of aluminium light alloy, with external bolts in stainless steel and RAL 7000 epoxy vinyl coating, are available in accord to all different requirements because of their big choice of control and signalling units; it is also available a special model of EFD1 with an emergency button and break glass, complete of external accessories (chain, hammer, glass stop ring, etc) in stainless steel and RAL 3000 external epoxyvinil coating.



Technicals data:

Materials	Body and cover aluminium alloy Screws in stainless steel
Inhibiting treatment	Standard epoxy painting Grey RAL7000
Electrical elements	
Rated Insulation voltage	Ui 660V (CEI 60947-5-1) 300V (CSA C22-2 n,14) lith 10A
Dielectric strenght	3KV (1s)
Insulation resistance	2 Mohm min (500VCC)
Initial contact resistance	<=25m. Ohm
Short circuits protection	Fuses gl 10A 500V 10.3 x 38 II 100KA
Terminals marking	EN 60079-0(2006), EN 60079-1(2007), EN 61241-0(2006), EN 61241-1(2004)
Connections	Self cleaning type EN01 (NC) EN10 (NO)
Operation frequency	1800 operations/hours maxi
Utilization categories	AC15 Voltage(V)-24-130-230-400 Current(A) 10-6.5-4- 2.5 DC13 Voltage (V) -24-110 Current (I) -1.5-0.5

Technical drawing:

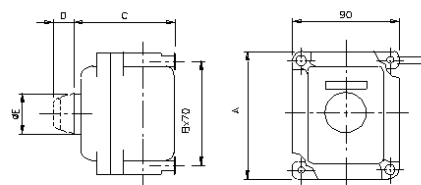

Elements	Symbole	D	E	Contacts	Weight(g)
Commut 3p	C2	21	12	2NO+2NC	300
Inter 2p	I2	21	45	2NO	300
Inter 2p +	D2	21	45	2NO+2NC	300

Type	Elément s	Entres câbles		Dimensions			Poids Gr
		Ø	Nbres	A	B	C	
EFD1	1	3/4"	2	106	86	87	480

Elements	
Commutators	
Voltage / Current	380 VAC / 10 A

*With incandescent lamps		
Gas	Dust	Tamb
T6	T85°C	-50/ +40°C
T5	T100°C	-50/ +50°C
T4	T135°C	-50/ +60°C

*Commands units only		
Gas	Dust	Tamb
T6	T85°C	-50/ +60°C

EFD1 -C2
 Boitier 1 élément
 Elément 1 : Commut 3p