



NP-EM Nipples and couplings

Mode de protection:

Type of protection: II 2 G EEx d IIC
 Class of temperature: T6
 Protection degree: IP65
 Certificate: CESI 01 ATEX 104U

Description:

The NP nipples and the EM couplings are accessories cylindrical shaped, with ends male threaded (NP) and female threaded (EM).
 To connect either female threaded entries or male threaded pipes.



Technical data:

Materials:

Body: galvanized steel.

Thread:

UNI 6125 (ISO 7/1).

On request:

Other types of thread.

Technical drawing:

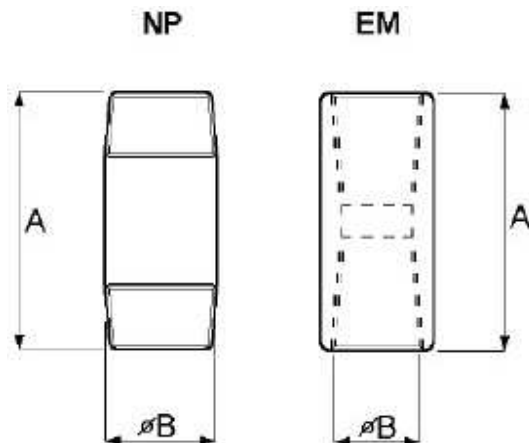

| Type | Dimensions (mm) | |
|-------|-----------------|----|
| | Ø B | A |
| NP 1 | 1/2" | 55 |
| NP 2 | 3/4" | 55 |
| NP 3 | 1" | 65 |
| NP 4 | 1.1/4" | 65 |
| NP 5 | 1.1/2" | 65 |
| NP 6 | 2" | 65 |
| NP 7 | 2.1/2" | 85 |
| NP 8 | 3" | 85 |
| NP 10 | 4" | 85 |
| NP 12 | 5" | 85 |

| Type | Dimensions (mm) | |
|-------|-----------------|----|
| | Ø B | A |
| EM 1 | 1/2" | 45 |
| EM 2 | 3/4" | 45 |
| EM 3 | 1" | 55 |
| EM 4 | 1.1/4" | 60 |
| EM 5 | 1.1/2" | 60 |
| EM 6 | 2" | 60 |
| EM 7 | 2.1/2" | 70 |
| EM 8 | 3" | 70 |
| EM 10 | 4" | 70 |
| EM 12 | 5" | 75 |