



RTFI206CTM1500 ATEX Antenna GPS

Mode of protection:

Type of protection: II 2G Ex d IIB
 Class of temperature: T5
 Ambient temp: -20/+40°C
 Zones: 1-2

Description:

ATEX antenna GPS 1,575.42MHz for gas zones (1 & 2).
 Lightweight and compact, **body in stainless steel AISI316L**,
 antenna in nickel plated brass. Unarmoured cable gland M20 kit
in stainless steel AISI316L (seals 5.5/8 - 8/10.5 - 10.5/13mm).
 TNC female connector. Hazardous tank level monitoring,
 offshore platforms, chemical processing, power plants...



References:

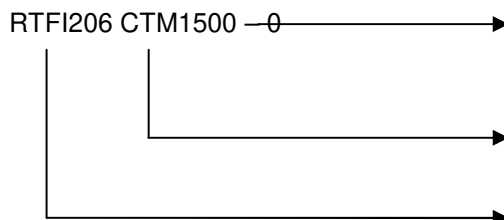

Length of cable

0 : without cable
 5 : 5 meters of cable
 10 : 10 meters of cable
Other length on request

Antenna

1,575.42MHz

Enclosure model

RTFI206

RTFI206CTM1500 1,575.42MHz

Approx height (mm):

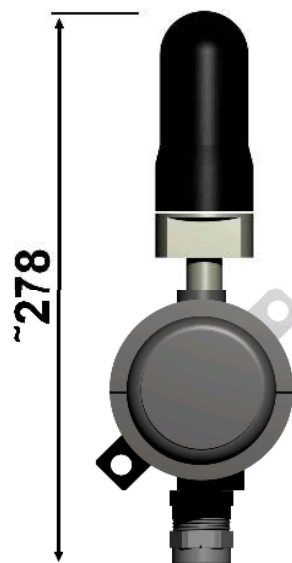

Other models on request:

RTFI206CTM800 Dual band 824-896 MHz & 1850-1990 MHz
RTFI206CTM801 Dual band 801-940 MHz & 1901-2000 MHz
RTFI206CTM900 915 MHz
RTFI206CTM5000 5.0 GHz
RTFI206CTM401 450MHz to 470MHz
RTFI206CTM2400 2.4GHz

Antenna technicals data :

-Frequency: 1,575.42MHz
 -Impedance: 50Ω
 -Gain: 0.0 dBi
 -Max Power: 2 Watts
 -Connector : female TNC



RTFI206CTM1500 ATEX Antenna GPS

Drawing:

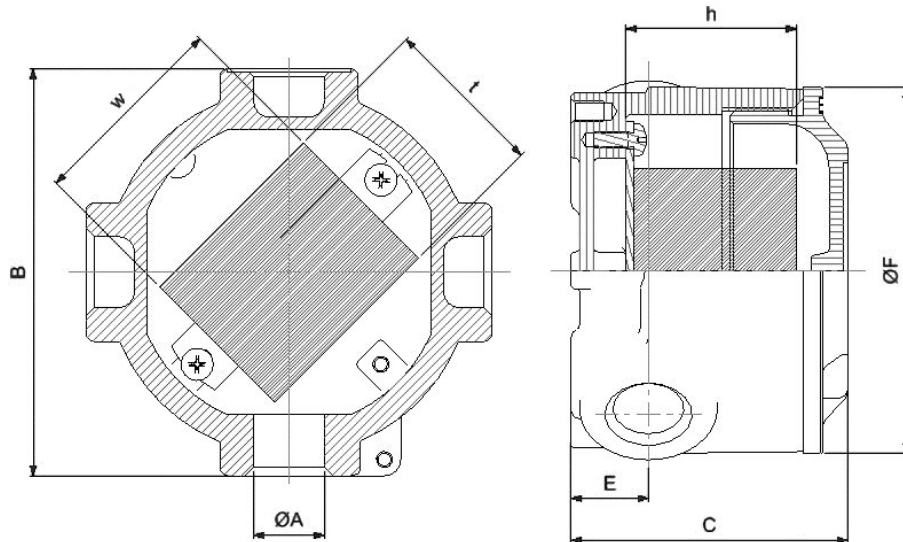

Enclosure dimensions	ØA	Dimensions externe (mm)					Dimensions interne (mm)			Volume elec. (dm ³)	Poids (kg)
		External dimensions (mm)					Internal dimensions (mm)				Weight (kg)
		B	C	D	E	F	h	W	t		
RTFI206CTM1500	M20	100	68	9.5	22.5	22.5	40	50	35	0.070	1.25



Fixation	Dimensions (mm)						Poids (kg)
Bracket	A	B	C	D	E	F	Weight (kg)
KF6S	126	18	3	6.5	10	108	50

Example with furniture cable

