



RTFI206CTM900 – ATEX GSM Antenna

Mode of protection:

Type of protection: II 2G Ex d IIB
 Class of temperature: T6
 Ambient temp: -20/+40°C
 Zones: 1-2

Description:

The CTM-Series of antennas are designed for use in “Hazardous-Classified” and Industrial-Hardened applications. The antennas are omni-directional with 2.0 dBi gain and designed for flexible mounting with an M20 thread. The mounting base is made of heavy nickel-plated brass with an integrated TNC coaxial connector for ease of installation. The radome is optimized for rugged industrial applications while maintaining maximum radio frequency transmission and reception efficiency. Unarmoured cable gland M20 kit (seals 5.5/8 - 8/10.5 - 10.5/13mm).

Enclosure body and cable gland in stainless steel AISI316L



References:

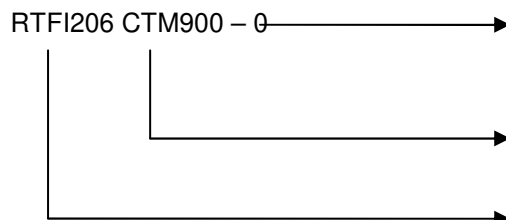

Length of cable

0 : without cable
 5 : 5 meters of cable
 10 : 10 meters of cable
Other length on request

Antenna

902-928MHz

Enclosure model

RTFI206

RTFI206CTM900 902-928MHz

Approx height (mm):

Other models on request:

RTFI206CTM800 Dual band 824-896 MHz & 1850-1990 MHz
RTFI206CTM801 Dual band 801-940 MHz & 1901-2000 MHz
RTFI206CTM2400 2.4 GHz
RTFI206CTM5000 5.0 GHz
RTFI206CTM401 450MHz to 470MHz
RTFI206CTM1500 1,575.42MHz

Antenna technicals data :

- Frequencies: 902-928MHz
- UL listed & ATEX certified
- Internal seal fitting
- Custom frequencies available
- TNC connector
- Mounting: 20mm (M20) thread
- Rugged Nickel Plated Brass mounting base

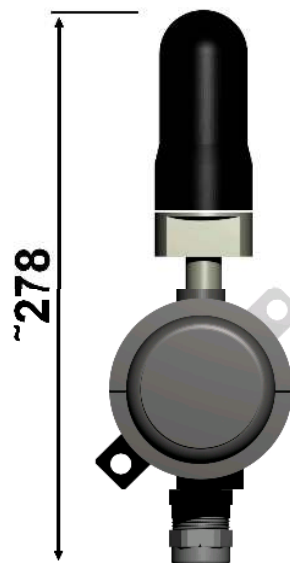



RTFI206CTM900 – ATEX GSM Antenna

Drawing:

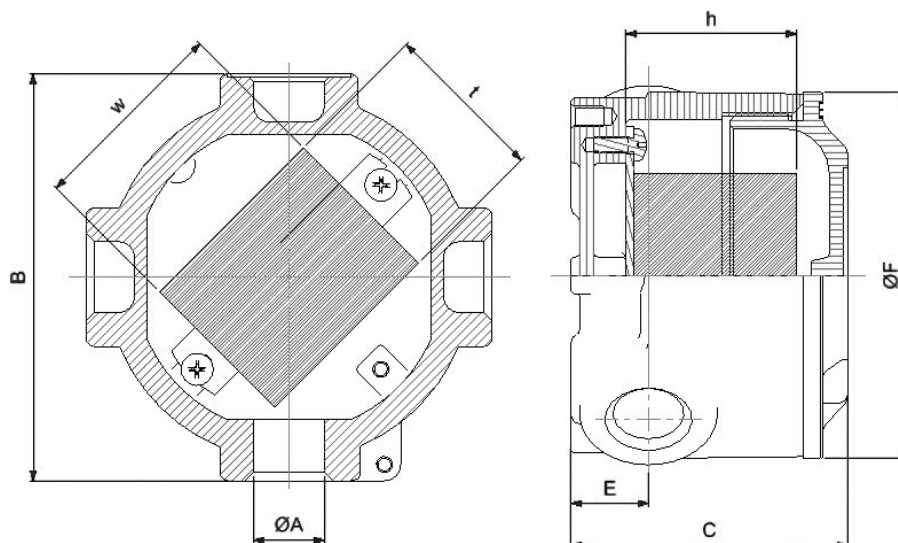

Enclosure dimensions	ØA	Dimensions externe (mm)					Dimensions interne (mm)			Volume elec. (dm ³)	Poids (kg)
		External dimensions (mm)					Internal dimensions (mm)				Weight (kg)
		B	C	D	E	F	h	W	t		
RTFI206CTM900	M20	100	68	9.5	22.5	22.5	40	50	35	0.070	1.25



Fixation	Dimensions (mm)						Poids (kg)
Bracket	A	B	C	D	E	F	Weight (kg)
KF6S	126	18	3	6.5	10	108	50

Example with furniture cable

