



RTFI257CTM1500 ATEX Antenna GPS Lighting arrestor TNC Plug to TNC Bulkhead Jack 0-6 GHZ

Mode of protection:

Type of protection: II 2G Ex d IIB
Class of temperature: T5
Ambiant temp: -20/+40°C
Zones: 1-2

Description:

ATEX antenna GPS 1,575.42MHz for gas zones (1 & 2).
Lightweight and compact, **body in stainless steel AISI316L**,
antenna in nickel plated brass. Unarmoured cable gland M20 kit
in stainless steel AISI316L (seals 5.5/8 - 8/10.5 - 10.5/13mm).
TNC female connector. Hazardous tank level monitoring,
offshore platforms, chemical processing, power plants...



References:

RTFI257 CTM1500 – 0

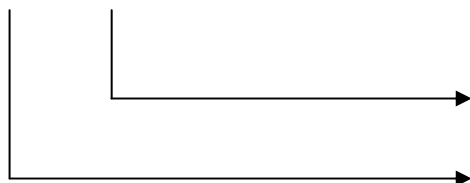

Length of cable

0 : without cable
5 : 5 meters of cable
10 : 10 meters of cable

Antenna

1,575.42MHz

Enclosure model

RTFI206

RTFI257CTM1500 1,575.42MHz

Approx height (mm):

Other models on request:

RTFI257CTM800 Dual band 824-896 MHz & 1850-1990 MHz

RTFI257CTM801 Dual band 801-940 MHz & 1901-2000 MHz

RTFI257CTM900 915 MHz

RTFI257CTM5000 5.0 GHz

RTFI257CTM401 450MHz to 470MHz

RTFI257CTM2400 2.4GHz

Antenna technicals data :

- Frequency: 1,575.42MHz
- Impedance: 50Ω
- Gain: 0.0 dBi
- Max Power: 2 Watts
- Connector : female TNC

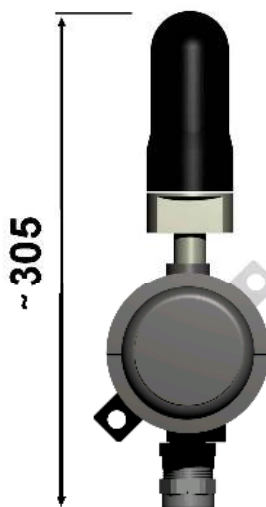



RTFI257CTM1500 ATEX Antenna GPS

Lighting arrestor TNC Plug to TNC Bulkhead Jack 0-6 GHZ

Drawing:

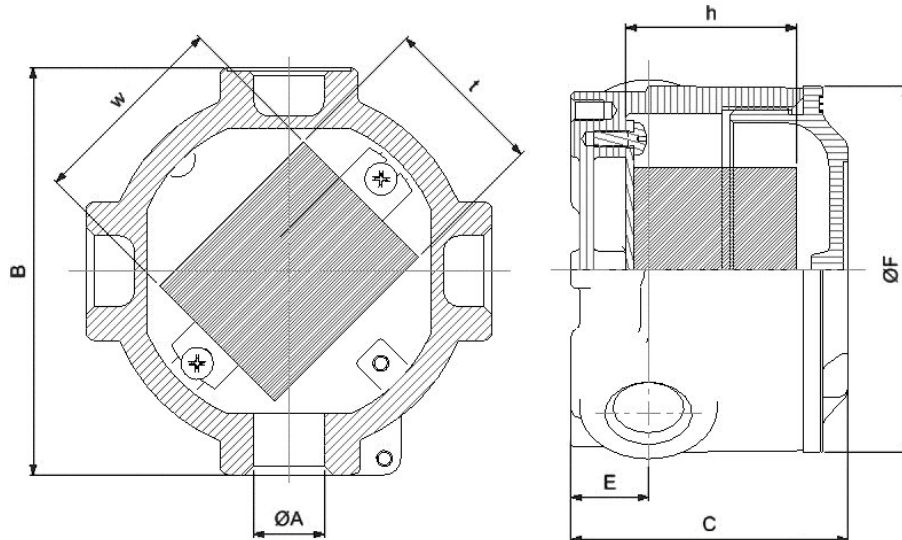

Enclosure dimensions	ØA	Dimensions externe (mm)					Dimensions interne (mm)			Volume elec. (dm ³)	Poids (kg)
		External dimensions (mm)					Internal dimensions (mm)				Weight (kg)
		B	C	D	E	F	h	W	t		
RTFI257CTM1500	M20	126	82	11	24	112	50	65	45	0.146	2.20



Fixation	Dimensions (mm)						Poids (kg)
Bracket	A	B	C	D	E	F	Weight (kg)
KF7S	142	18	3	6.5	10	124	57

Example with furniture cable





RTFI257CTM1500 ATEX Antenna GPS Lighting arrester TNC Plug to TNC Bulkhead Jack 0-6 GHz

Lighting arrester



Specifications	
Model	TW-LP-TNC-P-BHJ
Frequency Range	DC 0-6 GHz
Insertion Loss	.01dB/1GHz, .02dB/2GHz, .04dB/3GHz, .05dB/5GHz, 0.6dB/6GHz
VSWR	DC~6 GHz <1.5
Impedance	50 Ω
Connector	TNC Plug To TNC Bulkhead Jack
Operating Temperature Range	-86°F to 185°F
Dimensions	(L x W x H) 0.9" x 2.4" x 1.2"
Insulation Resistance	DC 100V More Than 50 MΩ
DC Discharge Voltage	90 V
Initial Impulse Wave Discharge Voltage	Less Than 700 V (1KV/μs)
Rated Impulse Wave Discharge	20 KA (Wave 8/20 μs) 10 Times (5 Times Each Polarity)
Weight	0.28 lbs
Ground Connection	By Feedthrough or Screw Terminal
Recommended AWG	18 AWG ground wire

