



RTFI257CTM2400 ATEX Wi-Fi Antenna

with lightning arrestor
RPTNC Plug to RPTNC Bulkhead Jack 0-6 GHz

Mode of protection:

Type of protection: II 2G Ex d IIB
Class of temperature: T6
Ambiant temp: -20/+40°C
Zones: 1-2

Description:

ATEX Wi-Fi antenna 2.4GHz for gas zones (1 & 2). Lightweight and compact, **body in stainless steel AISI316L**, antenna in nickel plated brass. Maximum power output dissipated 2W. Unarmoured cable gland M20 kit **in stainless steel AISI316L** (seals 5.5/8 - 8/10.5 - 10.5/13mm). Reverse Polarity TNC male right connector to solder. Hazardous tank level monitoring, offshore platforms, chemical processing. power plants...



References:

RTFI257 CTM2400 – 0

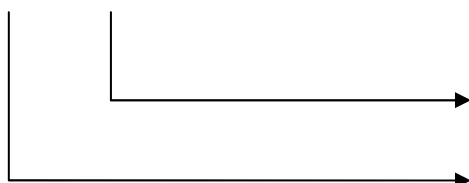

Length of cable

0 : without cable
5 : 5 meters of cable
10 : 10 meters of cable

Antenna

2,4 GHz

Enclosure model

RTFI257



RTFI257CTM2400 2.4 GHz
RTFI257CTM5000 5 GHz

Approx height (mm):

Other models on request:

RTFI257CTM800 Dual band 824-896 MHz & 1850-1990 MHz
RTFI257CTM801 Dual band 801-940 MHz & 1901-2000 MHz
RTFI257CTM900 915 MHz
RTFI257CTM401 450MHz to 470MHz
RTFI257CTM1500 1,575.42MHz

Antenna technicals data :

-Frequency: 2.4 GHz
-Impedance: 50Ω
-Gain: 2.0 dBi
-Max Power: 2 Watts
-Connector : Reverse polarity female TNC (2.4GHz)
& TNC female (5GHz)

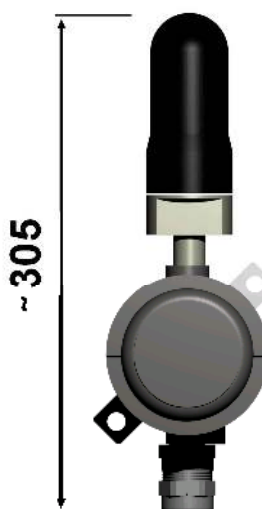



RTFI257CTM2400 ATEX Wi-Fi Antenna with lightning arrester RPTNC Plug to RPTNC Bulkhead Jack 0-6 GHZ

Drawing:

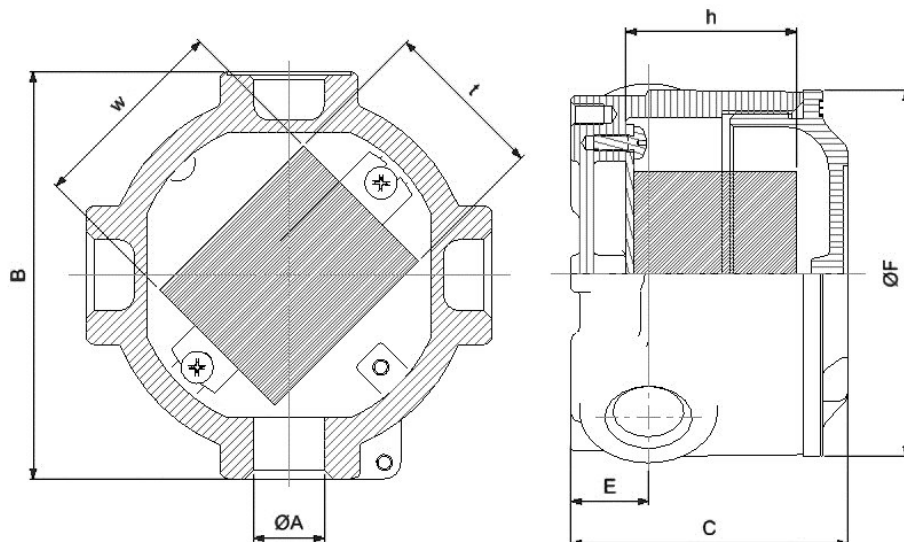

Enclosure dimensions	ØA	Dimensions externe (mm)					Dimensions interne (mm)			Volume elec. (dm ³)	Poids (kg)
		External dimensions (mm)					Internal dimensions (mm)				Weight (kg)
		B	C	D	E	F	h	W	t		
RTFI257CTM2400	M20	126	82	11	24	112	50	65	45	0.146	2.20



Fixation	Dimensions (mm)						Poids (kg)
Bracket	A	B	C	D	E	F	Weight (kg)
KF7S	142	18	3	6.5	10	124	57

Example with furniture cable





RTFI257CTM2400 ATEX Wi-Fi Antenna with lightning arrestor RPTNC Plug to RPTNC Bulkhead Jack 0-6 GHz

Lightning arrestor



Specifications	
Model	TW-LP-RPTNC-P-BHJ
Frequency Range	DC 0-6 GHz
Insertion Loss	≤0.7 dB
VSWR	DC~6 GHz <1.5
Impedance	50 Ω
Connector	RPTNC Plug To RPTNC Bulkhead Jack
Operating Temperature Range	-40°F to 185°F
Dimensions	(L x W x H) 0.9" x 2.7" x 1.1"
Insulation Resistance	≥2000 MΩ
DC Discharge Voltage	90 V
Initial Impulse Wave Discharge Voltage	450-500 V (1KV/μs)
Rated Impulse Wave Discharge	20 KA (Wave 8/20 μs) 10 Times (5 Times Each Polarity)
Weight	0.21 lbs
Ground Connection	By Feedthrough or Screw Terminal
Recommended AWG	18 AWG ground wire

