



Thermostat TA-TAI

Protection mode:

Type of protection: IIC GD EEx d IIB+H²
 Class of temperature: T6-T5
 Protection degree : IP65
 Ambient Temp : -20°/ +60°C
 Zones : 1-21-2-22



Description:

The TA (external regulation) and TAI (internal regulation) room thermostats consist of a body in aluminium alloy, complete with sump including the liquid dilatation probe. SPDT contact.

Wiring Diagram

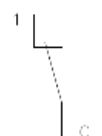

Technical data:

Materials:
 Body: aluminium alloy.
 Sump: galvanized brass.

Cables entry:
 Entry \varnothing 3/4" UNI 6125 (ISO 7/1).

Inhibiting treatments:
 Epoxy painting RAL 7000.

Application:
 Suitable for regulation of room temperature.

On request:
 Thermostats with different setting ranges.
 Entry 3/4" NPT or M25x1.5 ISO 262

Technical drawings:

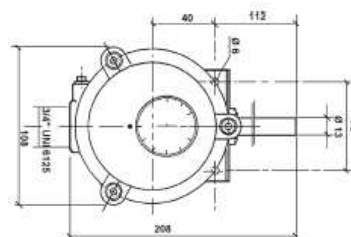
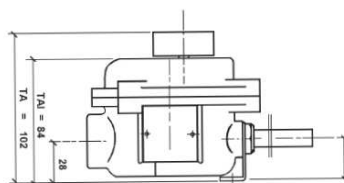

Dimensions table:

Type	Entry \varnothing A	Setting range °C	Max. Bulb temp °C	Differential $\Delta t = \text{°C}$	Rated current (A)	Max Voltage (Vac)	Max Voltage (Vcc)
TA 40	3 / 4 ' UNI 6125	0-40	50	2	10A	400Vac	250 Vcc
TAI 40	3 / 4 ' UNI 6125	0-40	50	2	10A	400 Vac	250 Vcc